

SPECIFICATIONS

Rated thermal input	5,9 kW
Efficiency	84 %
Smoke flue diameter	180 mm
Min. thrust (under pressure) for rated thermal input	12 Pa
Fuel gas temperature	215 °C
Volume of fuel gas	4,9 g/s
CO emissions in fuel gas (at 13 % O ₂)	0,0943 %
Dust in the fuel gas (at 13 % O ₂)	18 mg/Nm ³
Volume of fuel per hour	1,84 kg/h
Fuel	wood (beech logs)
Weight	144 kg



LIST OF SPARE PARTS

Glass



750 x 468 mm

Carcon stones

1. Front bottom
2. Back bottom
3. Back
4. Right side
5. Left side
6. Deflector
7. Carcon blind

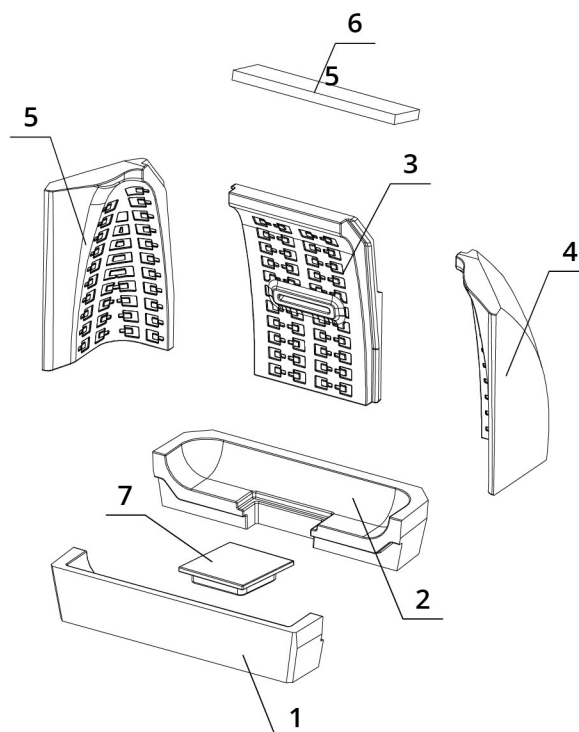

BEF FEEL 8 PASSIVE

BLOWER DOOR
TEST

ČSN EN
13229

eco
design

www.befhome.com

TECHNICAL DRAWING

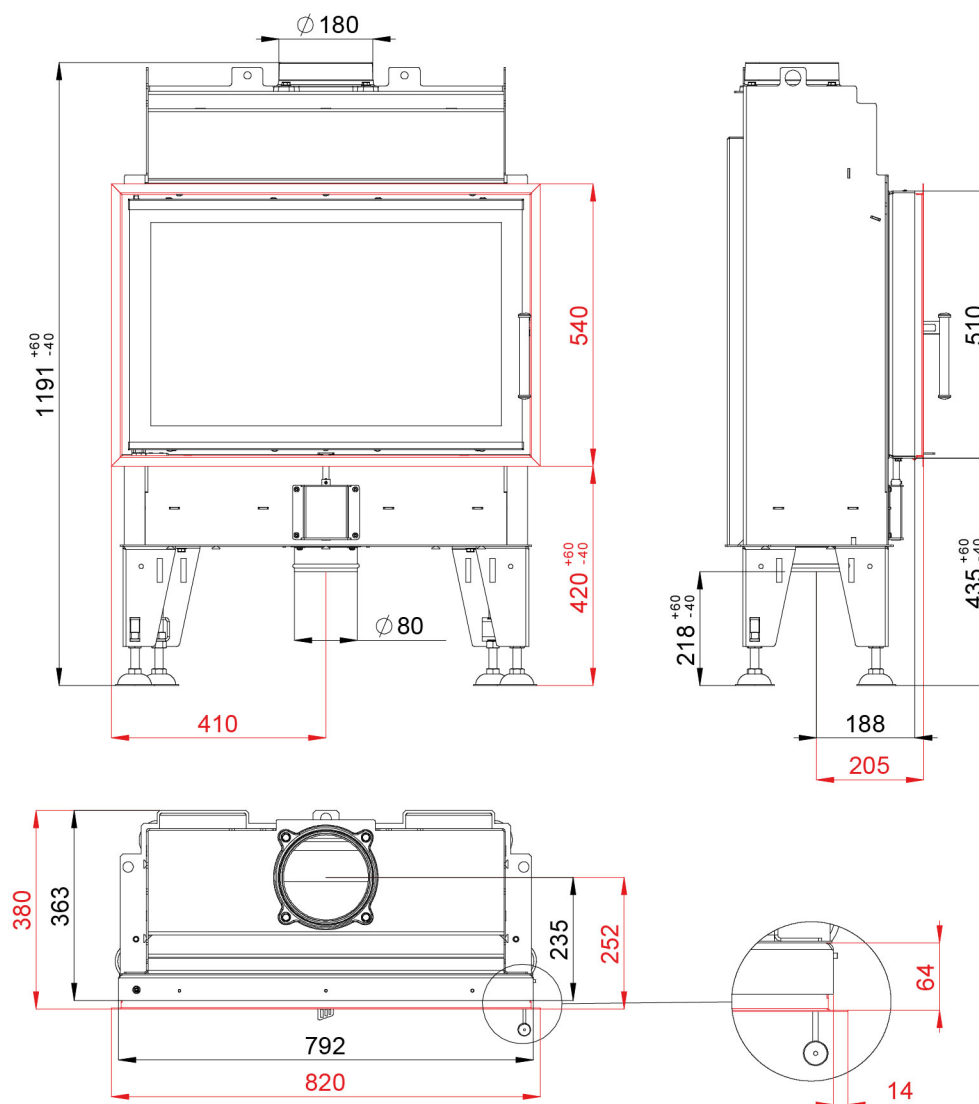

BEF FEEL 8 PASSIVE

BLOWER DOOR
TEST

ČSN EN
13229

eco
design

www.befhome.com